

INDUSTRIAL FOR LEASE

2931 S Tejon St. | Englewood, CO 80110



LEASE RATE
\$12.50/SF NNN



EST NNN
\$6.00/SF



SPACE AVAIL.
6,200 SF



ZONING
I-1

SUMMARY

2931 S Tejon Street is a 6,200 SF warehouse in Englewood Industrial Park featuring 18' clear heights and dual loading capabilities with 12' drive-in door and dock-high platform. Located 5 minutes from the Santa Fe & Hampden/285 interchange provides quick highway access. Open free-span warehouse with, office finish including reception, private offices, and large bullpen area. Flexible I-1 industrial zoning accommodates many warehousing or industrial uses.

HIGHLIGHTS

- Dual loading: 12' drive-in door + dock-high platform
- Flexible I-1 Zoning
- 18' Clear Span Warehouse
- Ideal office to warehouse split
- 3 Phase Power

NORTHPEAK TEAM

DREW WILLIAMS

Senior Advisor
(303) 917-5232

Drew@NorthPeakCRE.com

ZACH RODRIGUEZ

Advisor
(720) 692-4097

Zach@NorthPeakCRE.com

BEN TRAUT

Advisor
(847) 703-0951

Ben@NorthPeakCRE.com



NORTHPEAK[®]
COMMERCIAL ADVISORS

INDUSTRIAL FOR LEASE

2931 S Tejon St. | Englewood, CO 80110



NORTHPEAK TEAM

DREW WILLIAMS

Senior Advisor
(303) 917-5232

Drew@NorthPeakCRE.com

ZACH RODRIGUEZ

Advisor
(720) 692-4097

Zach@NorthPeakCRE.com

BEN TRAUT

Advisor
(847) 703-0951

Ben@NorthPeakCRE.com

INDUSTRIAL FOR LEASE

2931 S Tejon St. | Englewood, CO 80110



NORTHPEAK TEAM

DREW WILLIAMS

Senior Advisor
(303) 917-5232

Drew@NorthPeakCRE.com

ZACH RODRIGUEZ

Advisor
(720) 692-4097

Zach@NorthPeakCRE.com

BEN TRAUT

Advisor
(847) 703-0951

Ben@NorthPeakCRE.com

INDUSTRIAL FOR LEASE

2931 S Tejon St. | Englewood, CO 80110

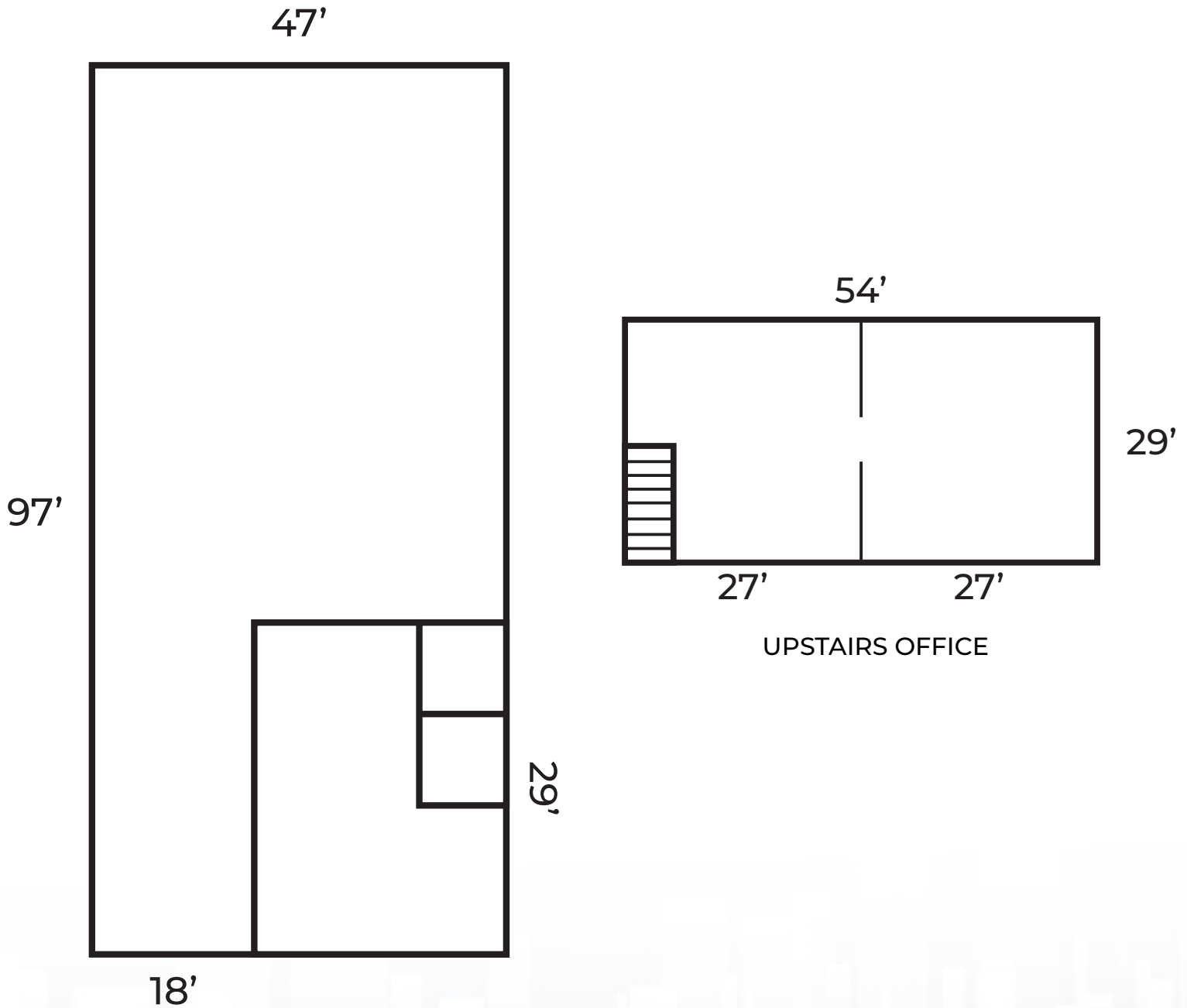

NORTHPEAK TEAM

DREW WILLIAMS

Senior Advisor
(303) 917-5232

Drew@NorthPeakCRE.com

ZACH RODRIGUEZ

Advisor
(720) 692-4097

Zach@NorthPeakCRE.com

BEN TRAUT

Advisor
(847) 703-0951

Ben@NorthPeakCRE.com

INDUSTRIAL FOR LEASE

2931 S Tejon St. | Englewood, CO 80110

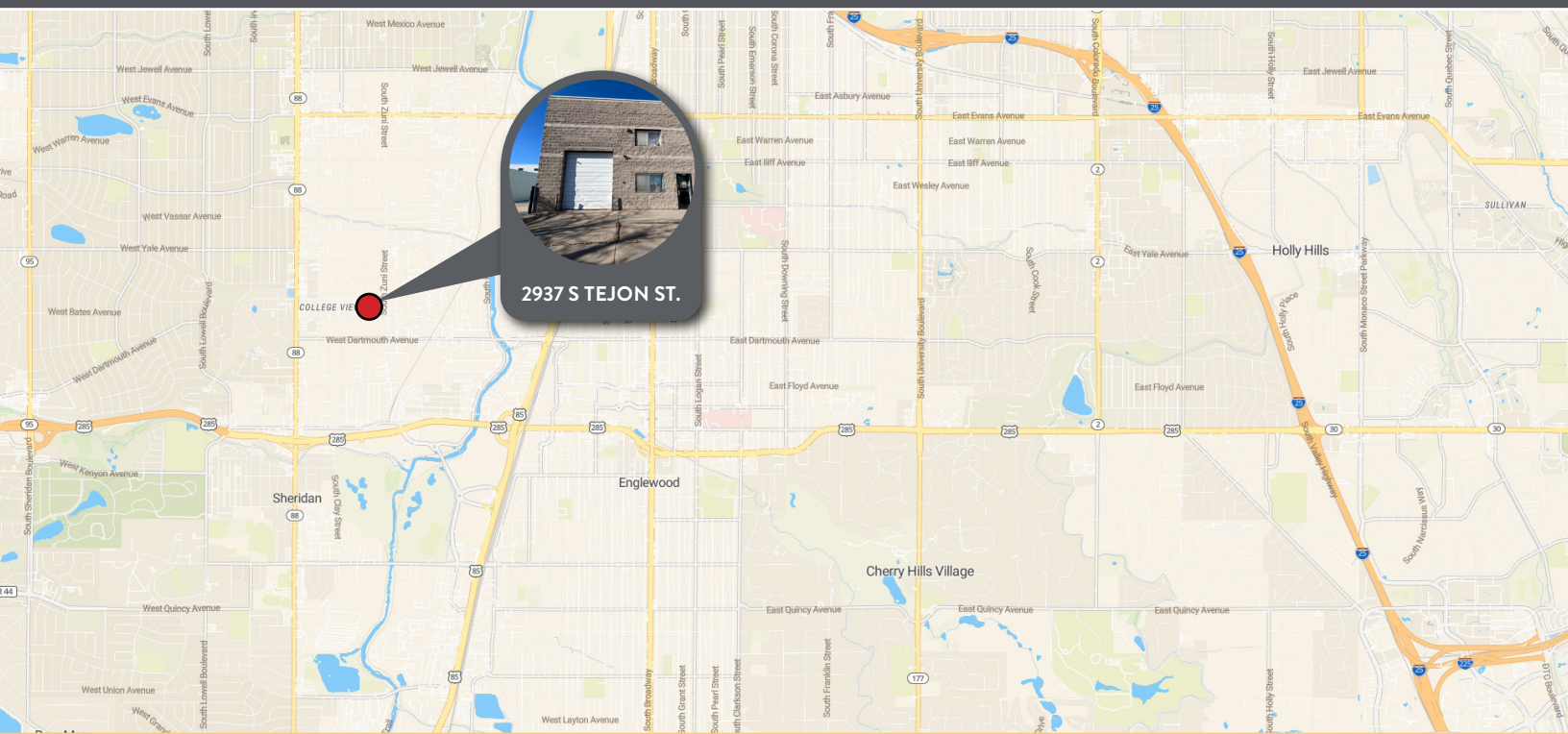

NORTHPEAK TEAM

DREW WILLIAMS

Senior Advisor
(303) 917-5232

Drew@NorthPeakCRE.com

ZACH RODRIGUEZ

Advisor
(720) 692-4097

Zach@NorthPeakCRE.com

BEN TRAUT

Advisor
(847) 703-0951

Ben@NorthPeakCRE.com